

---

SOREG®-glide | M Series *Luxury Line*

---

## Maximum frame reduction.

With a narrow 16 mm middle profile in carbon, we emphasise our Swiss ingenuity.

---



## SOREG®-glide | M Series Luxury Line

Puristic use of forms meets high-quality construction. A minimalist support structure combined with innovative materials make the M Series a unique, frameless sliding window system that represents exceptional design and outstanding structural properties.

The M Series offers aesthetic, functional and energy-efficient solutions for demanding, modern architecture. Thanks to its exceptionally narrow face width, the 16 mm middle profile in carbon offers maximum transparency. The blind and window profile consist of insulating material throughout (composite material) and impresses thanks to its high thermal insulation capacity, high resistance with low weight, long durability without maintenance.

- + flush, seamless transitions thanks to a low threshold
- + blind and window frames exclusively from highly-insulating composite materials (GRP)
- + continuously flush thanks to a lateral closing profile
- + continuous middle profile without visible attachment points
- + sound-proofed roller profile
- + face width middle profile
  - 16 mm carbon middle profile (GRP)
  - 30 mm aluminium middle profile
- + leaf sizes
  - Fixed leaf: max. 12 m<sup>2</sup> | Sliding leaf: max. 8 m<sup>2</sup>
- + leaf weight: up to 700 kg (with electronic drive)
- + glass thickness up to 54 mm
- + Uf value of 0.9 W/m<sup>2</sup>K | Uw-value of less than 0.8 W/m<sup>2</sup>K possible
- + rollers and running surface in stainless steel
- + easy and secure drainage thanks to the specific geometry of the GRP profile
- + insect screen



The GRP profiles selected for their thermal insulation value consist of insulation material throughout (composite material) and score points thanks to their high thermal insulation capacity, high resistance with low weight, long durability without maintenance and low emissions during production and use.

Electric drive  
 Insect screen  
 Triple glazing up to 54 mm building depth  
 Sound insulation measurement: 46 dB

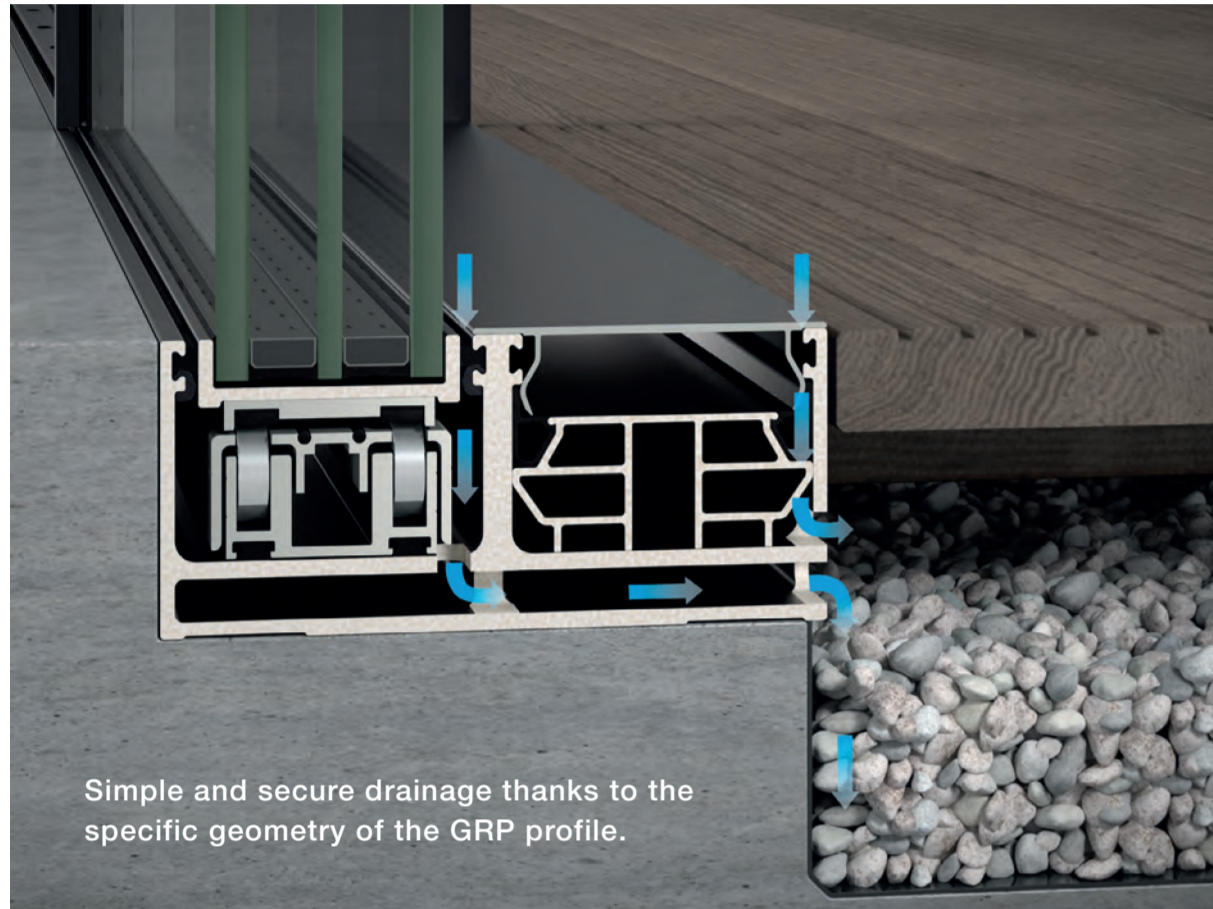

Simple and secure drainage thanks to the specific geometry of the GRP profile.

**FACTS**

**Element sizes**

Size of fixed leaf: up to 12 m<sup>2</sup>  
 Size of sliding leaf: up to 8 m<sup>2</sup>

**Weight of sliding leaf**

Manually-operated: up to 350 kg  
 With motor: up to 700 kg

**Glass thickness**

46 – 54 mm

**Building depth**

1-track: 80 mm  
 2-tracks: 160 mm  
 3-tracks: 240 mm  
 4-tracks: 320 mm

**Profile depth**

70 mm

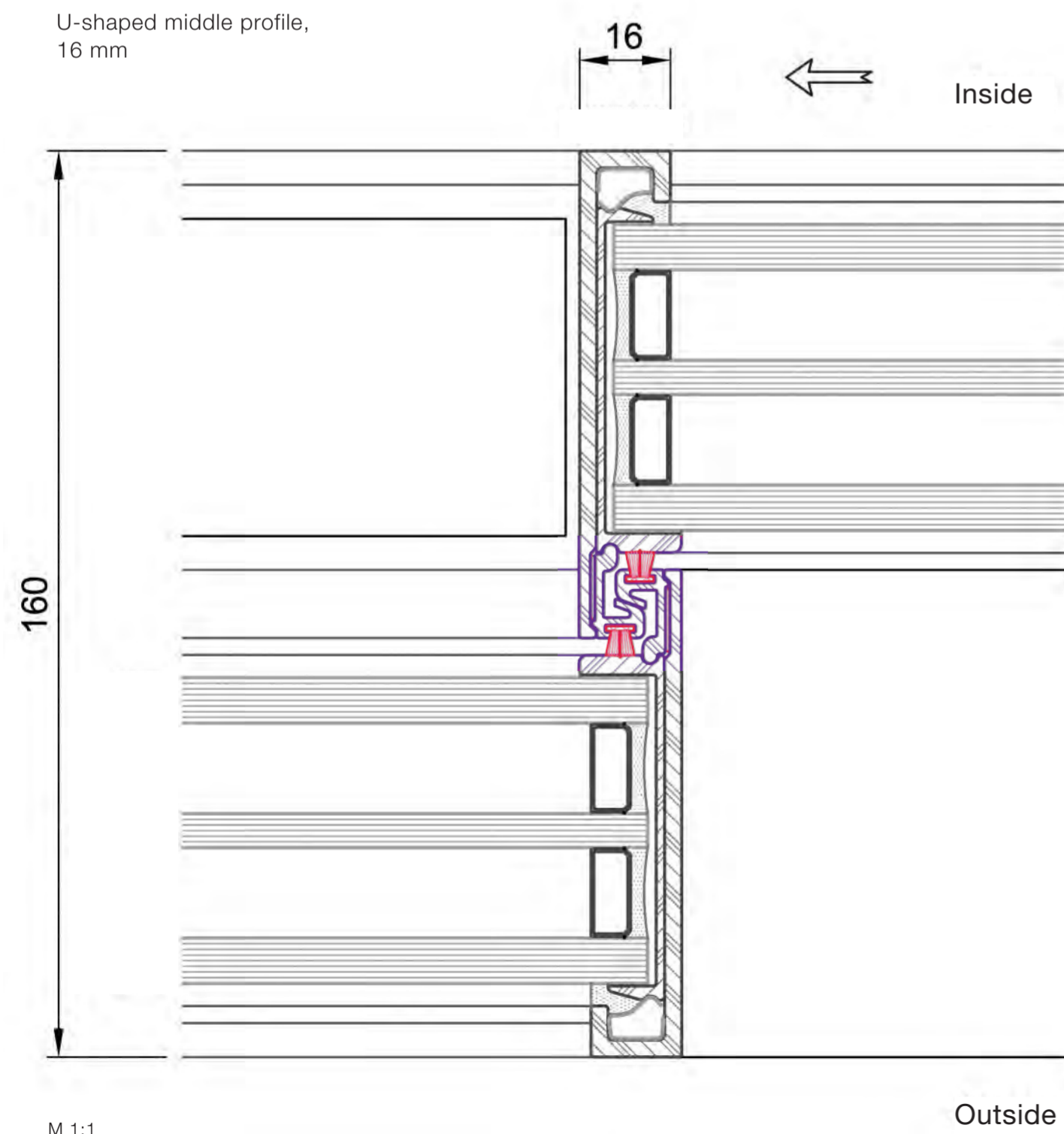

M 1:1

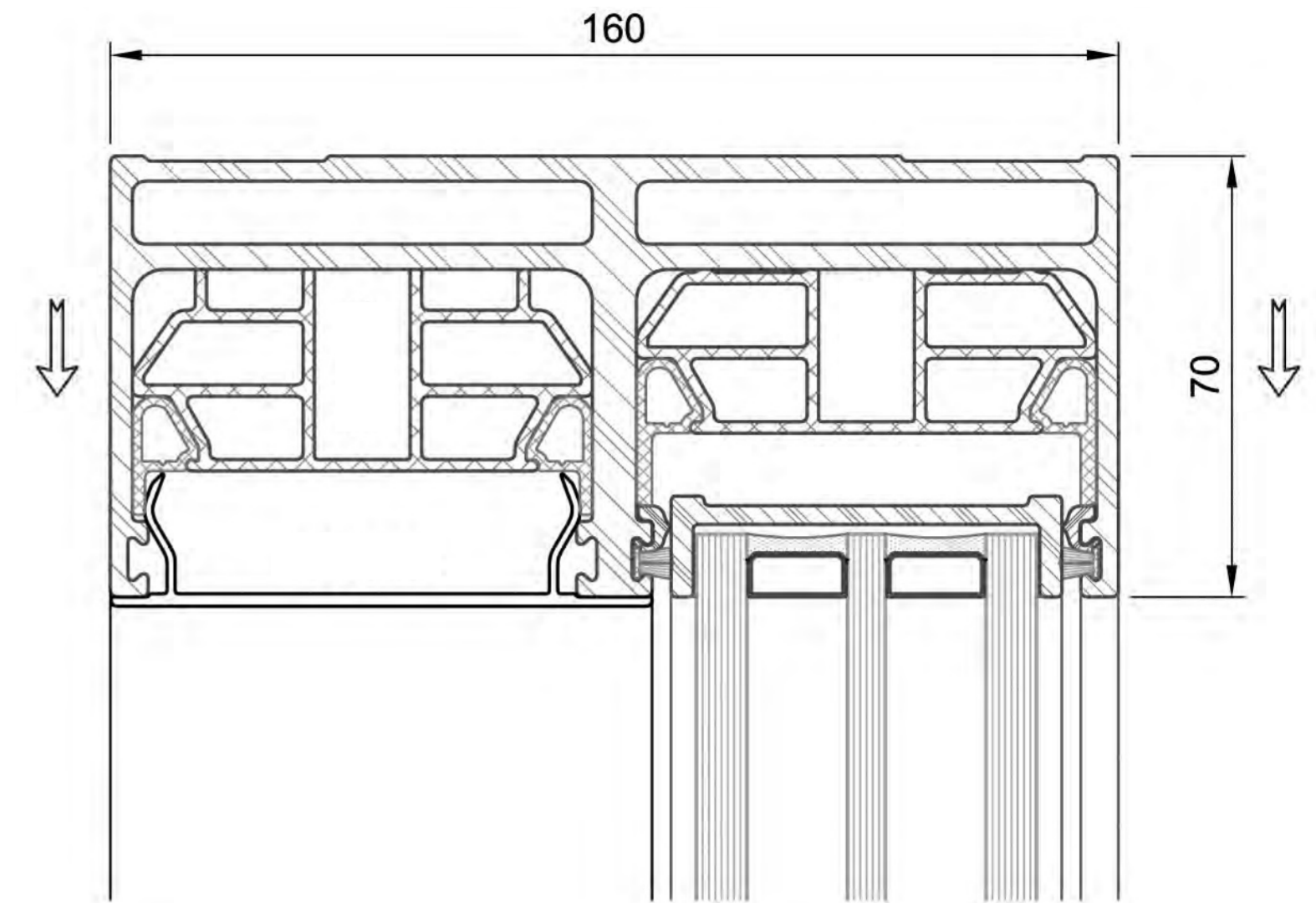

Outside

Inside

Section through sliding leaf

- 1 Dropped threshold**  
Automatic threshold cover, 100% accessibility.
- 2 Robust runner fitting**  
Large-sized, closed stainless steel with high load capacity.
- 3 Noise reduction**  
Insulating profiles for quiet and comfortable running.
- 4 Straight profiles**  
Continuous, lateral buffer profiles. Increased joint tightness with wind loads.
- 5 Brush sealing**  
Additional brush sealing completes the highly-insulating properties.

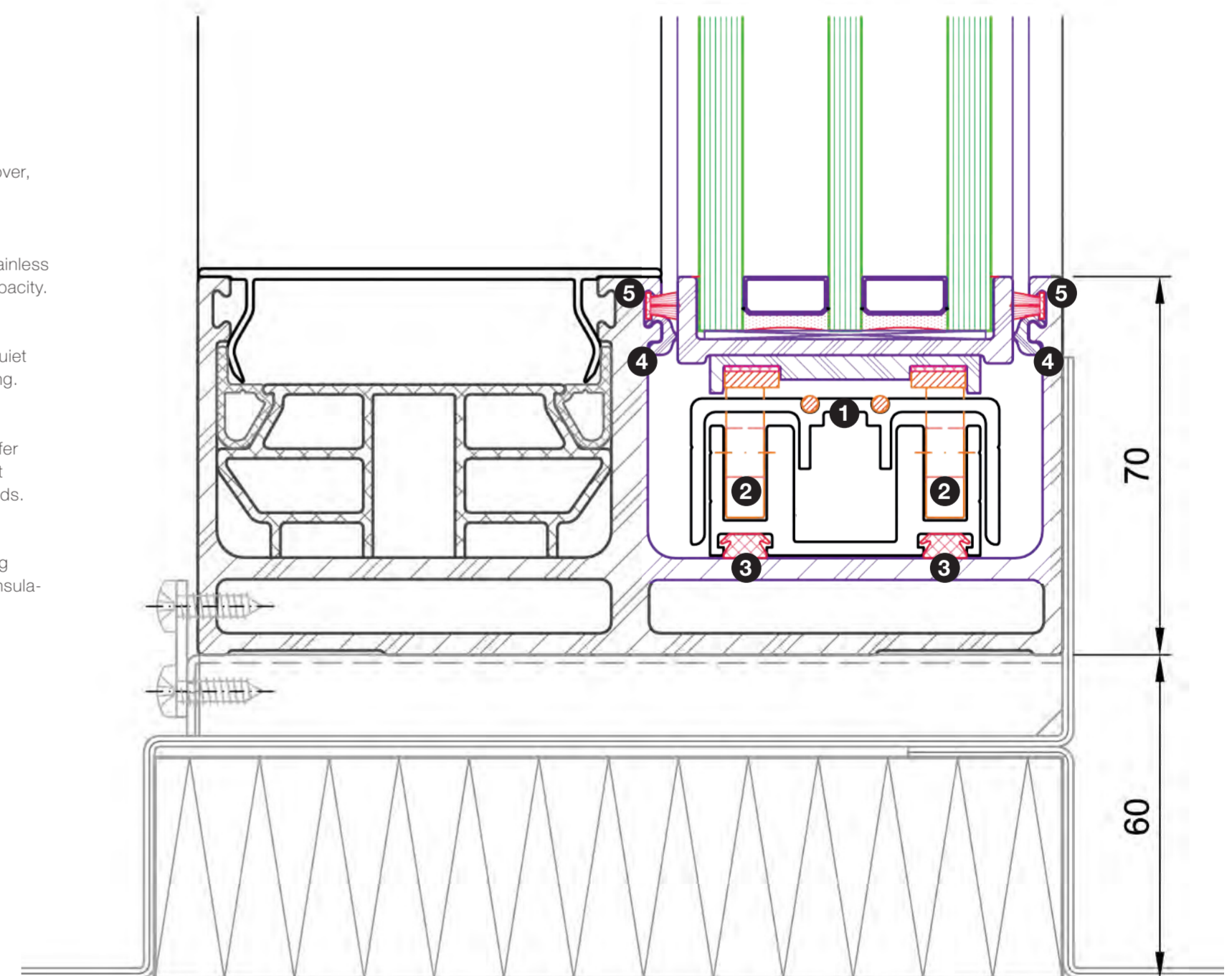

M 1:1

Part of **SCHÜCO**

Das **SOREG**<sup>®</sup>  
**rahmenlose**  
Fenster **GLIDE**<sup>®</sup>  
SWISS MADE

---

SOREG<sup>®</sup>-gliide · A trademark of SOREG AG · Industriestrasse 16 · CH-8820 Wädenswil  
Tel. +41 (0)44 782 88 20 · Fax +41 (0)44 782 88 21 · [info@soreg.com](mailto:info@soreg.com) · [www.soreg.com](http://www.soreg.com)